

ASSEMBLY INSTRUCTIONS

for telescopic jockey wheel to fit
drawbars from 40mm to 60mm square.

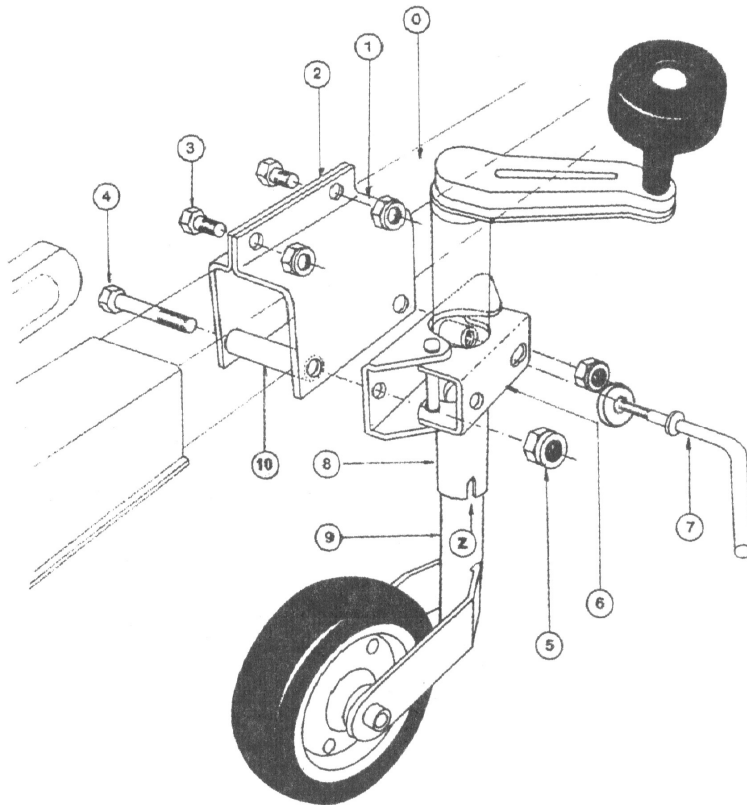

ADVICE :

Lightly grease the threads of the handle (7)

60mm Square
Drawbar

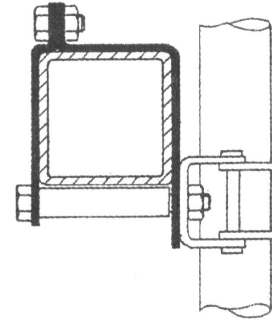

50mm Square
Drawbar

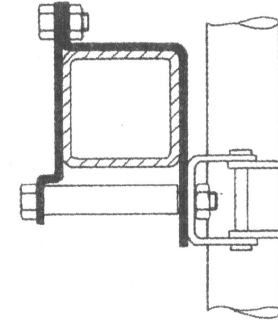

40mm Square
Drawbar

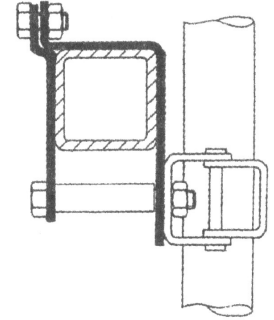

1. Assemble the steel clamp (1 & 2) around the draw bar (0). Secure in place by fitting the two top bolts and non slip nuts (3). Do not tighten fully at this point. Please note the position of the steel clamps as per drawings above, depending on bar dimensions.

2 bolts
HM 10x20

2 non slip
nuts M10

2. Fit the long bolts (4) through the steel clamp, using the spacers (10). At this point, fit the jockey wheel (6) in position, and secure with the non slip nuts (5), as per diagram.

2 bolts
HM 10x80

2 non slip
nuts M10

3. Tighten all nuts and bolts to ensure a tight fit.

4. Secure the sleeve of the jockey wheel in the jockey wheel clamp by using the handle (7) and the washer.

1 washer M12

IMPORTANT

**NEVER DRIVE WITH THE JOCKEY WHEEL DOWN.
WHEN TOWING YOUR TRAILER, ALWAYS LIFT UP THE JOCKEY WHEEL
UNTIL IT FITS IN POSITION (Z)**

- Once you have attached your trailer to your towing bracket, lift up the jockey wheel (9) using the handle, and continue until the wheel bracket almost touches the jockey wheel sleeve (8).
- At the point, turn the jockey wheel parallel to the draw bar, so that you can lift the wheel to its maximum height and the wheel brace fits in the cut (Z). To do this, unwind the handle (7) a few turns, then when completed, secure the handle tightly.